

耐用溫度 -20°C~100°C



2

外形尺寸表

VC 逆止閥

VC01~03

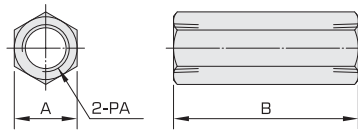

VC04 (G1/2")

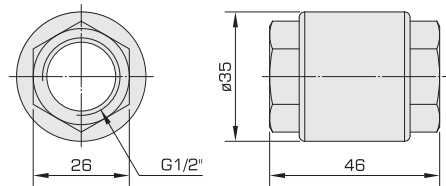

流量:3000NI/min

系列	流量(NI/min)	A	B	PA
VC01	470	14	40	G1/8"
VC02	1100	17	50	G1/4"
VC03	1900	21	50	G3/8"